



## Technical Data

# Roger™ Covert System

Roger™ Covert C, is a, state-of-the-art digital, wireless covert communications system. Roger Covert Dual C separable radio offers in addition a detachable wired radio link. This dual system allows use of both a professional portable radio and a Bluetooth®-connected device.

Roger™ is a digital standard, patented and developed by Phonak for the wireless, loop-less, encrypted and secure transmission of speech to low-power, miniaturized receivers.

## Description

### Roger Covert transmitter

- 1 Minimic MM11
- 2 Micro-USB
- 3 Radio connection <sup>B</sup>
- 4 On/Off button & LED
- 5 Connect button & LED
- 6 PTT button link to Bluetooth device
- 7 PTT button link to Bluetooth device <sup>A</sup> or PTT button link to wired device <sup>B</sup>
- 8 Bluetooth button & LED
- 9 Battery compartment

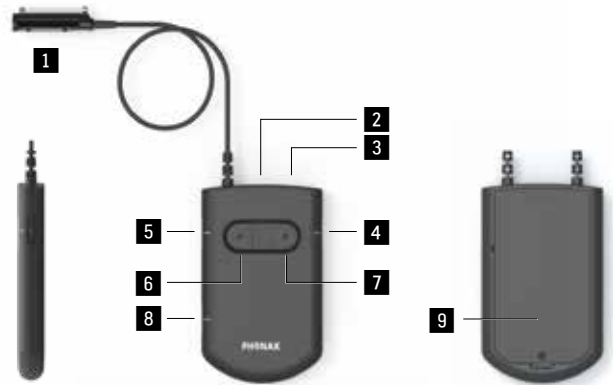

### Remote control

- 10 PTT button link to Bluetooth device <sup>A</sup>
- 11 PTT button link to Bluetooth device <sup>B</sup>
- 12 PTT button link to wired device <sup>B</sup>
- 13 LED Connect & battery status
- 14 Volume & mute button
- 15 Covert beep button
- 16 Key ring holder
- 17 Battery compartment

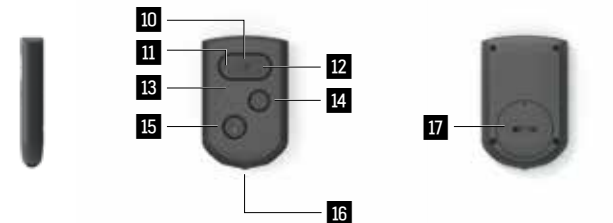

### Caption

<sup>A</sup> Roger Covert C and Roger Remote C

<sup>B</sup> Roger Covert Dual C separable radio and Roger Remote Dual C

## Features

### Roger Covert transmitter

#### Usability

- Slim and discreet design
- Feedback via on-demand indicator lights
- Integrated rechargeable battery
- Very simple system setup
- Fallback PTT button
- Several microphone length available at order

#### Connectivity

- Micro-USB socket for : charging and headphones

### Remote control

#### Usability

- Small and neutrally designed
- Designed for sightless operation
- Feedback via on-demand indicator light
- Inactivity detection for optimized battery lifetime
- Easily exchangeable battery

## General information

<b>Roger Covert C / Roger Covert Dual C separable radio</b>	
Dimensions (L x W x H)	92 x 56 x 12.5 mm (3.6" x 2.0" x 0.5")
Weight	75 g (2.65 oz)
Color	Black
Operating conditions	-10° to +60° Celsius (+14° to +140° Fahrenheit) and relative humidity of <95% (non condensing)
Charging conditions	0° to +45° Celsius (+32° to +113° Fahrenheit) and relative humidity of <90% for a long period
Transport and storage conditions	-20° to +60° Celsius (-4° to +140° Fahrenheit) and relative humidity of <90% for a long period
<b>Roger Remote C / Roger Remote Dual C</b>	
Dimensions (L x W x H)	62 x 40 x 11 mm (2.4" x 1.6" x 0.4")
Weight	22 g (0.78 oz)
Color	Black
Operating conditions	-10° to +60° Celsius (+14° to +140° Fahrenheit) and relative humidity of <95% (non condensing)
Transport and storage conditions	-20° to +60° Celsius (-4° to +140° Fahrenheit) and relative humidity of <90% for a long period

## Power and battery information

<b>Roger Covert C / Roger Covert Dual C separable radio</b>	
Battery type	Lithium polymer
Battery figures	1050 mAh - 3.7 VDC
Charging time	Approx. 2.5 h (Charging time depends on battery state)
Operating time in communication	> 13 h with battery at 80% of initial capacity
Charging input	Input: 100 - 240 VAC Output: 5 VDC/1 A Connector: Micro-USB
Cable length	1.3 m (4.2 feet) (charging or connection to computer for upgrade, service). The battery cannot be over-charged. It may become warm during charging. Important notice: It is recommended to only use the original Phonak charging unit.
<b>Roger Remote C / Roger Remote Dual C</b>	
Battery type	Button cell CR2032
Battery voltage	3 VDC
Operating time	> 3 month. Operating time depends on usage - Calculated with a 15 s PTT press, 12 times per hour and a 12h mission
Sleep mode current consumption	<22 µA. Remote control is equipped with an accelerometer and automatically turn to sleep mode after 7 min of inactivity

## Audio information

Audio bandwidth	100 Hz - 7200 Hz
SNR	55dB (@ 1 kHz)

## Microphone information

Microphone type	Directional
Signal processing applied	Noise cancelling and adaptive beamforming

## Encryption

Roger encryption	The audio transmission is secured with an AES (Advanced Encryption Standard) encryption where the code is exchanged at the time of (the manual) synchronization
Bluetooth encryption	EO
Key sizes	128-bits

## Roger information

Roger is a new wireless transmission technology, which allows low delay and reliable audio broadcasts to miniature, low-power receivers. Roger systems are based on Phonak's proprietary technology and ensure unmatched discretion, unrivalled intelligibility and unbeatable ease of use

Transmission technology	2.4 GHz adaptive frequency hopping
Power emission Roger Covert C	100 mW (20 dBm)
Power emission Roger Remote C	1 mW (0dBm)
On body Operating range to Roger Earpiece C	Max 0.5m (20")
On body Operating range of Roger Remote C	Max 0.5m (20")
Operating range for Connect feature	10 cm (4")

## Bluetooth information

Power emission	Bluetooth Class 2 = 2.5mW(4dBm)
Version	4.2
Profile	HFP or HSP
Compatible communication devices	Most popular professional radio brands Most popular Walkie-Talkie APP for Android

## Compatibility with Roger devices

Compatible Roger receivers	Roger Earpiece C, Roger Focus C
Compatible Roger transmitters	Roger CarKit C

## Optional accessories

Power supply adapter	UK, AUS
Carry	Leather chest pouch, Waiststrap

## Standards applied

Electrical safety	IEC/ EN 60950-1
Radiocom 2.4 GHz	EN 300 328
EMC	EN 301.489-1,-3,-9,-17
SAR (2.4 GHz)	EN 62311



\*The Bluetooth® word mark and logos are registered trademarks owned by the Bluetooth SIG, Inc. and any use of such marks by Phonak Communications AG is under license. Other trademarks and trade names are those of their respective owners.\*

